

# Roll it Up!

American Patchwork & Quilting

## 1 MILLION PILLOWCASE CHALLENGE



### materials

**For one pillowcase:**

- $\frac{3}{8}$  yard pink tone-on-tone (band)
- $\frac{7}{8}$  yard multicolor print (pillowcase body)

**Finished pillowcase:** 30×20" (fits a standard-size bed pillow)

**Quantities** are for 44/45"-wide, 100% cotton fabrics.

**Measurements** include  $\frac{1}{2}$ " seam allowances. Sew with right sides together unless otherwise specified.

Don't worry about loose threads or frayed edges. With the "burrito" method, a pillowcase with no exposed raw edges is easy to create. Follow these simple step-by-step photos to roll your own pillowcase in a jiffy!

1



From pink tone-on-tone, cut:

□ 1— 10×41" strip

From multicolor print, cut:

□ 1—26½×41" rectangle

Place pink strip right side up on work surface. Matching up long edges, put multicolor rectangle right side down atop pink strip. Pin edges together if desired.

2



Beginning at lower long edge, roll the multicolor rectangle toward the pink strip.

3



Stop rolling when you reach a point about halfway up the pink strip. The upper raw edges should still be aligned.

4

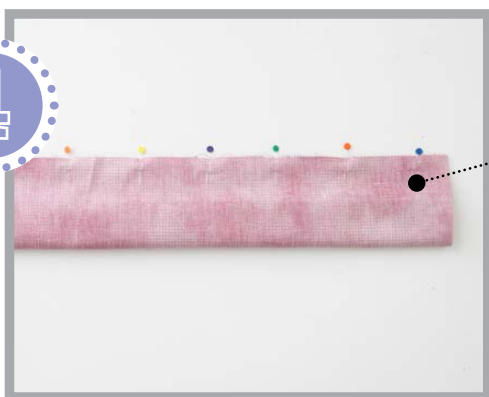

Wrap the pink strip around the rolled multicolor rectangle to form a tube. Pin the three raw edges together, making sure the rolled rectangle portion does not get pinned (*inset*).

5



Sew pinned edges together with a 1/2" seam allowance.

6



As if you were pulling a sleeve from a sweater, pull the multicolor print fabric from the tube, turning the pillowcase band right side out to make a pillowcase body.

7



Unroll the multicolor rectangle. All seam allowances should be encased within the pink pillowcase band.

8



Pulling slightly on the pink band, press the band flat with seam allowances going toward the band. Turn over and repeat to press opposite side.

*Look! No raw edges on either side of the band!*



# FRENCH SEAMS METHOD

1



To complete a fray-free pillowcase, finish it with French seams. That way, you'll have no raw edges exposed!

With wrong sides together (yes...wrong sides together) and a scant  $\frac{1}{4}$ " seam allowance, sew together the long raw edges of the pillowcase. For greatest accuracy, begin at the band and sew toward the opposite end. You may wish to pin the intersection where the band meets the body to make sure it aligns properly.

2

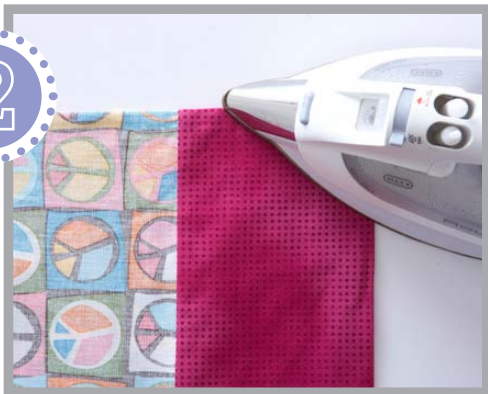

Turn the pillowcase wrong side out and press the seam allowance flat. For best results, you may need to roll the seam between your fingers to nudge it to the edge prior to pressing.

3



With the wrong side still out and using a  $\frac{1}{4}$ " seam allowance, sew the long edge of the pillowcase again, enclosing the seam previously sewn in Step 1.

4



Repeat steps 1-3 along the bottom raw edges to complete the pillowcase.

*Now, even the side seams are enclosed!*